

A New Wall
or Ceiling?

Never Been Easier!

Unique and Revolutionary!

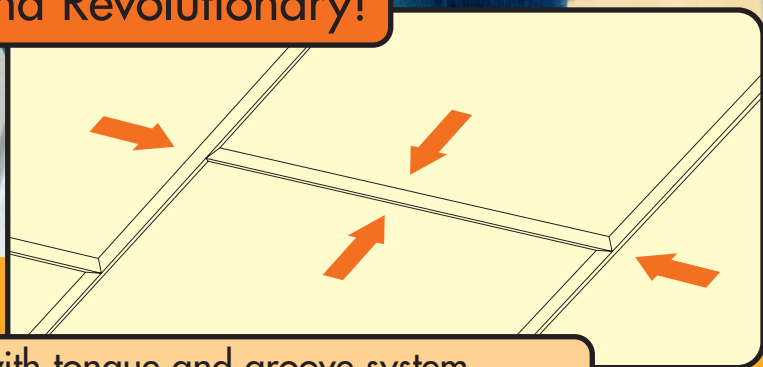

The first PVC panel with tongue and groove system
both in length and width

Give Yourself a *Head* Start...

6 Advantages!

- **Easy to transport** because of the short panels
- **Easy installation** with the unique Duma-Clip® system
- **No need for extra connection trims**
- **Budget friendly** because of minimum waste
- **Water-resistant**
- **Fire certificate class 1**

Duma-Clip®

Want to change the way your interior looks? Without the work taking three times as long as you thought and fraying those nerves to breaking point? Then Duma-Clip®, the latest wall and ceiling system from Dumaplast, is the answer. And you don't need to be a handyman, either!

With its unique joint system, you simply clip the Duma-Clip® panels to one another - quickly and easily. The result is bright and good-looking. Duma-Clip® is colourfast, water-resistant, budget-friendly and only requires a minimum of care and maintenance. Select any of the five colours available to give any room you want a whole fresh new look.

The short Duma-Clip® panels are also easy to transport.

Unique Joint System

NEW!

The new Duma-Clip® joint system also has a joint at the head of the panels that enables you to span any length of ceiling or wall. The panels can now be joined together on all sides so that you can clad the largest areas without any effort. There is no need for extra connection trims.

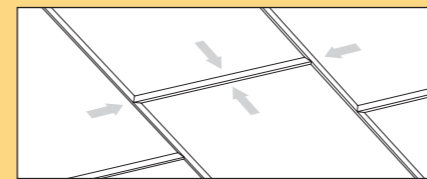
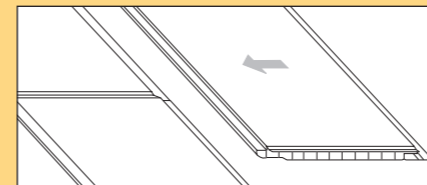
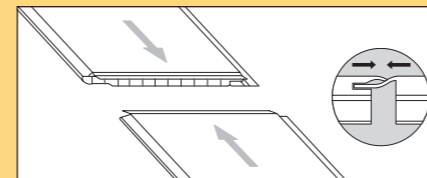

Installation

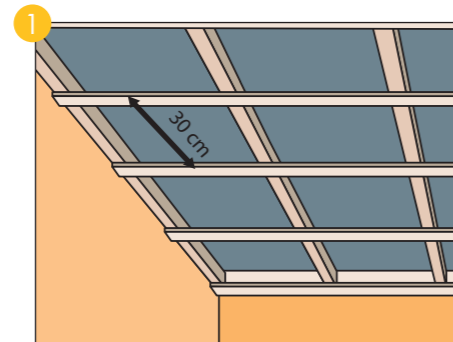

Build a framework with a cross distance of maximum 30 cm between the battens positioned perpendicularly to the direction of the panels. The panels can be glued directly on a smooth surface, and then a framework is not necessary.

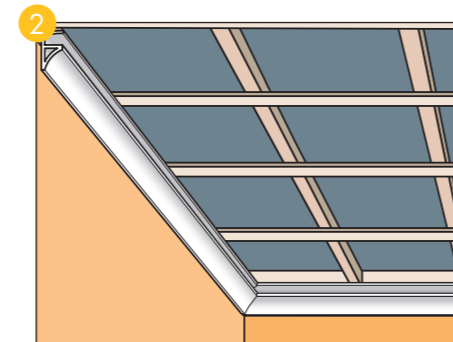

Put the first piece of the required trims into place with nails, staples or glue.

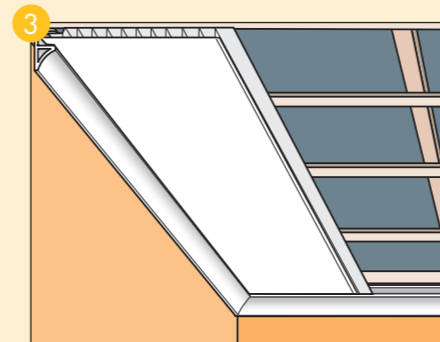

Put the first Duma-Clip® panel into the trims.

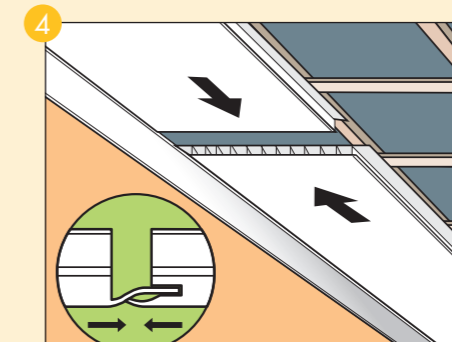

Connect the panels by their head end side by inserting the head lip completely into the groove as shown in the picture.

Always connect the panels evenly in a direct line with each other, so that the next row shows a perfectly parallel line. Build a complete row by fixing the panels to the framework by the side lip with nails, staples or glue. Cut the panel to size at the end.

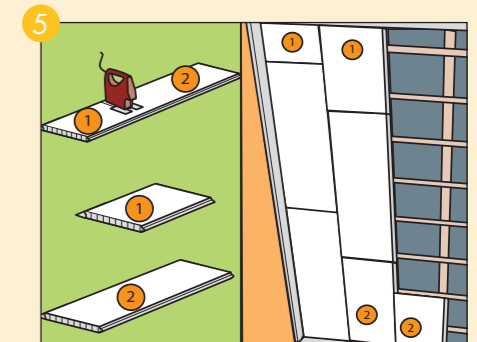

Take the remaining piece (at least 1.5 cm long) of the sawn panel and use this piece for the next row.

Build up a complete wall or ceiling this way and click the remaining piece of the trims into its place.



Colour Range



Trims

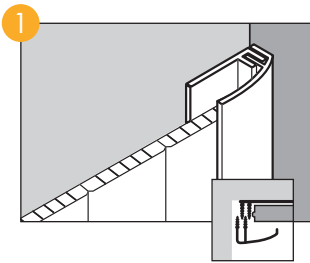

Start Trim

An end rail makes it possible to fit the panelling flush with the wall or ceiling. The first panel is best fitted into the end rail with a trimmed tongue side.

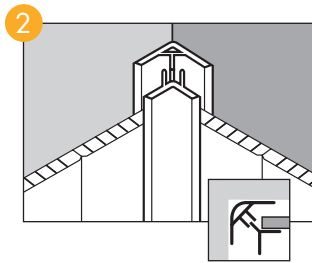

Universal Corner

Inside and outside corners can easily be finished with a universal corner rail, which is fitted before the panelling is applied.

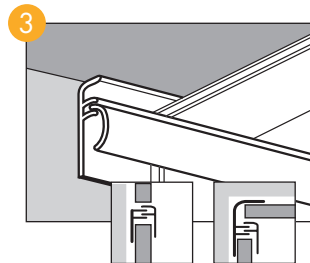

Multifunctional Trim

A perfect finishing against a wall or ceiling can be obtained with this trim for horizontal and vertical cornering. Can also be used as a start trim.

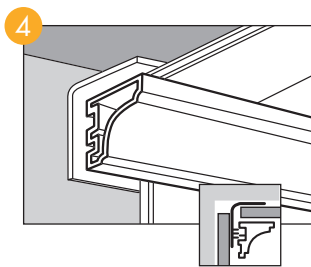

Decorative Crown Moulding

These special ceiling rails are used for finishing the ceilings after the panelling has been fitted and before the ceiling covering is applied.

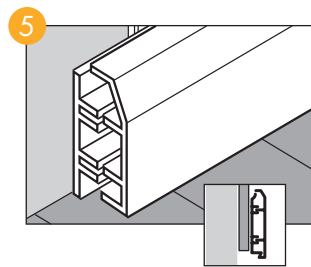

Skirting

Practical and attractive skirting boards conceal wiring and guarantee a perfect finish with the floor or wainscots.

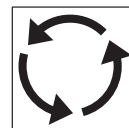
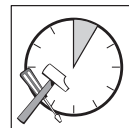
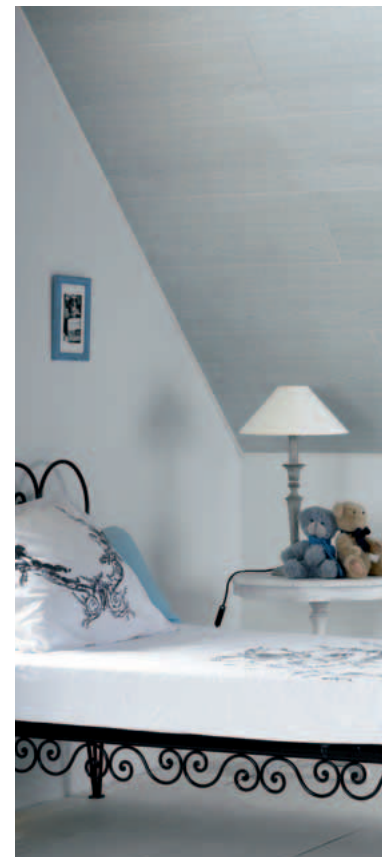

www.dumaplast.com

Your Duma-Clip® dealer:

Made in Belgium